

Comfortable and practical

All vacuum power in a unique inlet



NEW DESIGN



Easy installation

Simple and discreet

4 finishings available



Central vacuum systems
www.sistemair.com

The hose is there, but you can't see it

Vacuum inlet with retractable hose 



Easy installation



Complete



Easy operation



Easy electrical connection

PERFECT SEAL

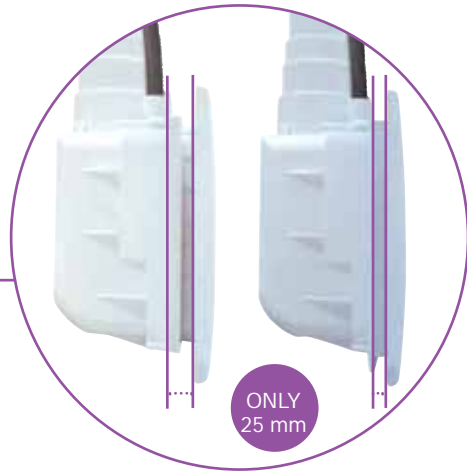
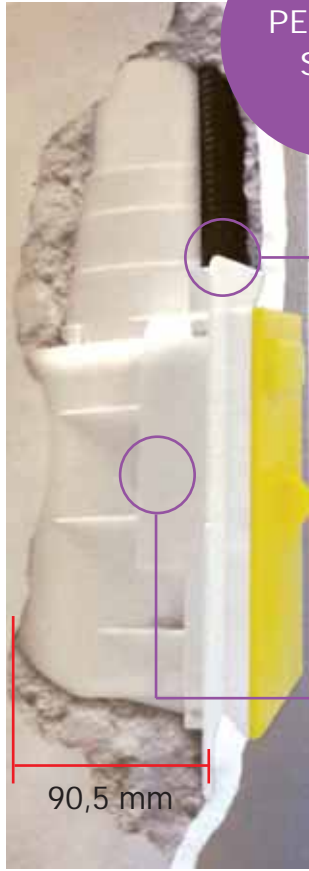

ONLY 25 mm

Up to 25 mm range to offer the **maximum versatility** in all installation cases

Switch on your central vacuum with the wireless handgrip Flisy



Innovative
Reliable
Comfortable
Light
Universal

5 SIMPLE GESTURES and you can forget about the hose

1 How to use the hose

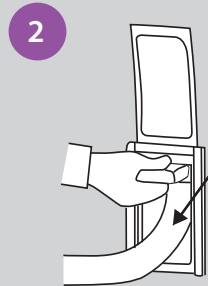

THE HOSE IS LOCKED AND YOU CAN START VACUUMING

How to store the hose

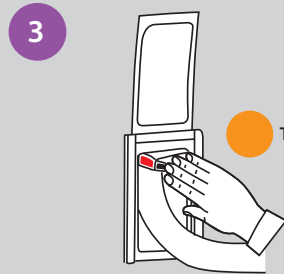

THE HOSE IS UNLOCKED

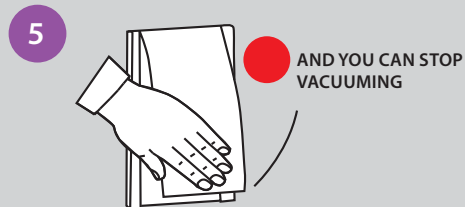
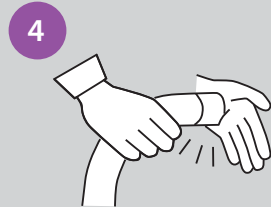

AND YOU CAN STOP VACUUMING

Art. 7230.1 Retraflex pre-installation kit for 1 inlet



1 x Retraflex vacuum inlet

1 x Retraflex inlet cover

2 x Wide elbow 22,5° 2"

2 x Wide elbow 45° 2"

3 x Wide elbow 90° 2"

1 x Glue 60 g

7 x Sleeve 2"

1 x Adapter 50 mm/2"

16 m Pipe 2"

Retraflex accessory kit



1 x Hose

1 x Handgrip

1 x Chromium plated telescopic pipe

1 x Mini accessory holder

1 x Floor brush

1 x Dusting brush

1 x Crevice tool

Art. 7232.9 (with 9 m hose)

Art. 7232.12 (with 12 m hose)

Art. 7232.15 (with 15 m hose)

Retraflex accessory kit (with hose protection)



1 x Hose with hose protection

1 x Handgrip

1 x Chromium plated telescopic pipe

1 x Mini accessory holder

1 x Floor brush

1 x Dusting brush

1 x Crevice tool

Art. 7232.9P (with 9 m hose + hose protection)

Art. 7232.12P (with 12 m hose + hose protection)

Art. 7232.15P (with 15 m hose + hose protection)

Art. 7039.4W Flisy handgrip and receiver



1 x Flisy wireless handgrip



1 x Flisy receiver board